

11TH INTERNATIONAL CONFERENCE ON ARCHAEOLOGICAL PROSPECTION



15-19 SEPTEMBER 2015, WARSAW

PROGRAMME

Plan of Old Library, University of Warsaw	2
Day 1, Tuesday 15.09.2015, (Old Library, University of Warsaw)	3
Poster session 1	5
Day 2, Wednesday 16.09.2015, (Old Library, University of Warsaw)	7
Poster Session 2	9
Day 3, Thursday 17.09.2015, (Old Library, University of Warsaw)	12
Poster Session 3	15
Day 4, Friday 18.09.2015, (Copernicus Science Centre)	17
Day 5, Saturday 19.09.2015, (Palace of King Jan III Sobieski in Wilanów)	20

USEFULL INFORMATIONS

Registration	21
Conference venues	21
Conference lunches	21
Events	22
Information for speakers	22
Internet access	23
Coming to the conference venue	23
Public transport	24
Emergency and assistance	25
Currency exchange	25
Electricity	25
A smartphone guide to events, food, clubs	25
WHAT YOU MUST SEE IN WARSAW	26

OLD LIBRARY, UNIVERSITY OF WARSAW

Ground Floor

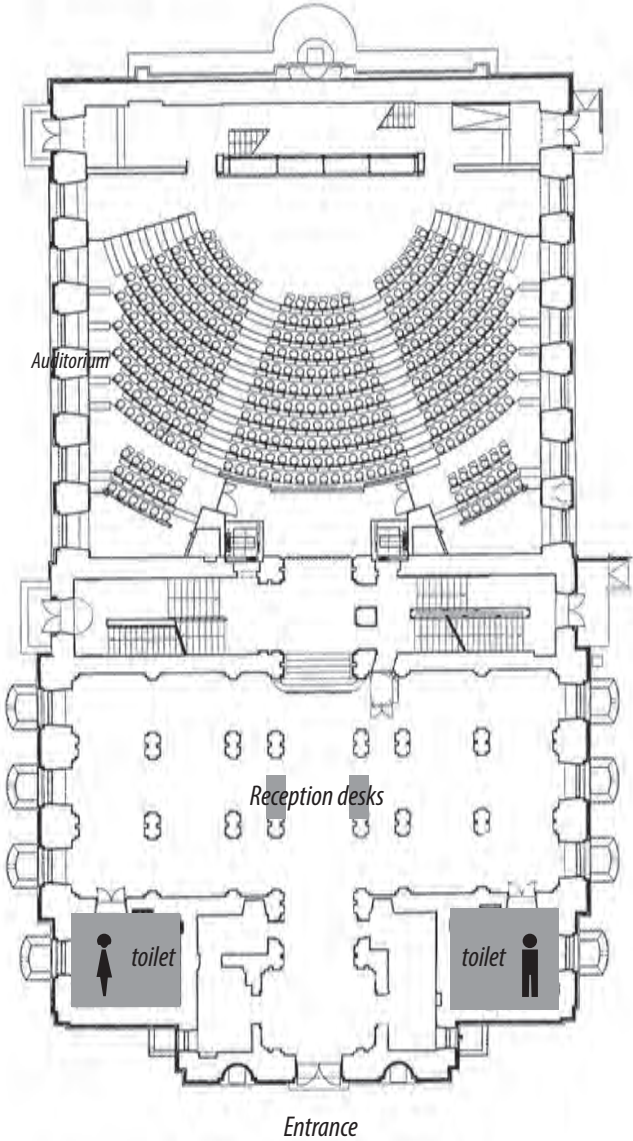

First Floor

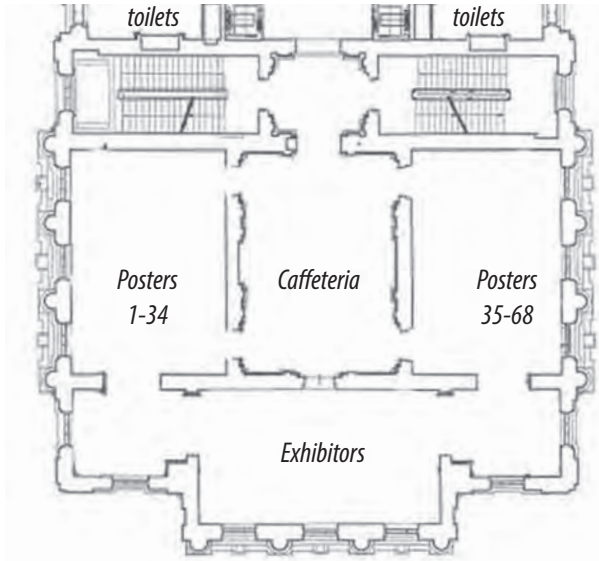

Second Floor

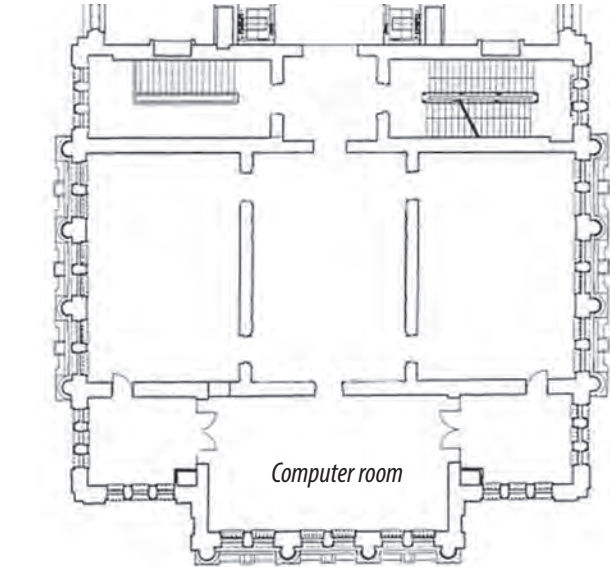

**DAY 1, TUESDAY 15.09.2015,
OLD LIBRARY, UNIVERSITY OF WARSAW**

8.30 - 10.00 Conference registration

10.00-10.20 Opening ceremony

Invited lectures, Session 1.

Chairman: Armin Schmidt

- 10.20-10.50 Alain Tabbagh
*Snapshots concerning the role of archaeology/
archaeometry in the birth and progress of geophysical
exploration*
- 10.50-11.20 Helmut Becker
*From proton- to caesium magnetometry: my 40 years
in archaeological prospection*
- 11.20-11.50 Albert Hesse
*Early experiments of new surveying methods for archae-
ology along the Nile Valley*
- 11.50-12.20 COFFEE AND TEA BREAK

Invited lectures, Session 2.

Chairman: Armin Schmidt

- 12.20-12.50 Włodzimierz Rączkowski
*Archaeology and remote sensing technology: (un)happy
couple with prospects?*
- 12.50-13.20 Michel Dabas, Pierre collardey, Sébastien Ruelleu
*From WW1 to World Files: Collaborative work in archae-
ology through the use of Internet technologies*
- 13.20-14.40 LUNCH

Integrated prospection approaches.

Chairman: Paul Linford

- 14.40-15.00 Immo Trinks, Wolfgang Neubauer, Michael Doneus, Alois Hinterleitner, Nives Doneus, Geert Verhoeven, Klaus Löcker, Matthias Kucera, Erich Nau, Mario Wallner, Sirri Seren
Interdisciplinary archaeological prospection at unprecedented scale and resolution. The first five years of the LBI ArchPro Research Initiative 2010-2015
- 15.00-15.20 Kayt Armstrong, Martijn van Leusen, Wieke de Neef
Going over old ground: what can landscape-scale magnetic susceptibility data do for me?
- 15.20-15.40 Andrei Asăndulesei, Cristi-Ionuț Nicu, Ștefan Balaur, Ștefan Caliniuc, Mihaela Asăndulesei, Vasile Cotiugă
Integrated prospection methods for documenting threatened prehistoric archaeological sites from north-eastern Romania
- 15.40-16.00 Rebecca Cannell, Jan Bill, Paul Cheetham, Kate Welham
The Gokstad Viking Age trading site: a voyage of physicochemical prospection
- 16.00-16.20 Andrzej Affek
Exploring past Carpathian landscape: the application of LiDAR and archival cadastral maps
- 16.20-16.50 COFFEE AND TEA BREAK

Integrated prospection approaches.

Chairman: Cornelius Meyer

- 16.50-17.10 Mahmut G. Drahor, Caner Öztürk, Buket Ortan, Meriç A. Berge, Atila Ongar
Integrated geophysical investigations at Şapinuva, a Hittite city in central Anatolia, Turkey
- 17.10-17.30 Sergey A. Erokhin, Igor N. Modin, Alexandra M. Pavlova
3D electrical resistivity imaging and GPR to re-explore ancient mounds near Suzdal in Russia
- 17.30-17.50 Ekhine Garcia-Garcia, Juantxo Agirre-Mauleon, Arantza Aranburu, Haizea Arrazola, Julian Hill, Joxe Etxegoien, Juanmari Mtz. Txoperena, Peter Rauxloh, Rafa Zubiria
The Roman settlement at Auritz (Navarre): preliminary results of a multi-system approach to assess the functionality of a singular area

- 17.50-18.10 Kristian D. Strutt, Angus Graham, Willem H. J. Toonen, Benjamin T. Pennington, Daniel Löwenborg, Virginia L. Emery, Dominic S. Barker, Morag A. Hunter, Aurélia Masson, Karl-Johan Lindholm
Manipulating mud: (re)constructing cosmogonical landscapes in the Nile Valley, Thebes, Egypt
- 18.10-19.00 POSTER SESSION 1
- 19.00-21.00 WELCOME COCKTAIL AT PAŁAC KAZIMIERZOWSKI (RECTORATE)

POSTER SESSION 1

1. Robert C. Bowman, Evelyn A. Combs
Community prospection: archaeological ground-penetrating radar analyses performed for and by the Healy Lake Village community, Interior Alaska
2. Jarrod Burks, Andreas Viberg, Bruce Bevan
Lightning strikes in archaeological magnetometry data. A case study from the High Bank Works site, Ohio, USA
3. Gianluca Catanzariti, Ildelfonso Ramírez González, Gianfranco Morelli
Extensive multi-channel GPR mapping over the site of the ancient Archiepiscopal Palace of Alcalá de Henares (Spain)
4. Giovina Caldarola, Laura Castrianni, Giuseppe Ceraudo, Immacolata Ditaranto, Veronica Ferrari, Ida Gennarelli, Francesco Pericci
Reading an ancient vicus with non-invasive techniques: integrated terrestrial, aerial and geophysical surveys at Aequum Tuticum (Ariano Irpino-Av)
5. Michael Wess, Clement Atzberger, Michael Doneus, Geert Verhoeven
ARCTIS – analysing hyperspectral datasets
6. Michael Herlesand, Jörg W.E. Fassbinder
Magnetic prospecting on basaltic geology: the lower city of Erebuni (Armenia)
7. Alin Frîncu elasa, Mădălina Nicoleta Frîncu elasa, Cornel David
Geophysical prospecting of the Yamnaya barrows (3rd millennium BC) from Ciorani de Jos, Prahova county, Romania
8. Akihiro Kaneda, Kazuhiko Nishiguchi, Yama Nawabi, Yoshiro Watanabe
Archaeological prospecting of kiln sites in the Samurai era
9. Maksym Mackiewicz, Bartosz Myślecki
Non-invasive research on medieval strongholds in Silesia. Case studies from Borucin (Silesian province) and Chrzelice (Opole province)

10. Peter Milo, Jan Zeman, Martin Bartík, Martin Kuča
Late Neolithic circular enclosures: never entirely uncovered
11. Peter Milo, Petra Goláňová, Jiří Grünseisen, Branislav Kovár, Arnaud Meunier, Igor Murín, Tomáš Tencer, Michal Vágner, Jan Zeman
On the trail of Caesar and Vercingetorix: survey in the Bibracte oppidum, Mont Beuvray (France)
12. Kourosh Mohammadkhani
The results of magnetic survey at the Bronze Age site of Shahr-e Sukhteh, Sistan, Iran
13. Patrick Nagy
The archaeological prospection project Rheinau (Switzerland)/ Jestetten, Altenburg (Germany)
14. Philippe Pelgas, Bruno Wirtz
French experience using sub-bottom profiler combined with sonar multi-beam as a preventive archaeological diagnostic before dredging
15. Alejandro Rosado-Fuentes, Alejandra Arciniega-Ceballos, Filiberto Vergara-Huerta
Seismic refraction tomography in the Texcoco Region, Mexico
16. Apostolos Sarris, Nikos Papadopoulos, Carmen Cuenca-García, Dimitris Alexakis, Meropi Manataki, Gianluca Cantoro
Exposing the Urban Plan of the ancient city of Hyettos, Boeotia, Greece
17. Apostolos Sarris, Nikos Papadopoulos, Eleni Kokkinou, Pantelis Soupios, Michael Teichmann, Kleanthis Simyrdanis, Georgia Kakoulaki, Dimitris Alexakis, Cristina Manzetti, Jean-Marc Luce
Uphill and downhill geophysical challenges in Delphi, Greece
18. Apostolos Sarris, Gianluca Cantoro, Rogier Kalkers, Jeremia Pelgrom, Tesse Stek
Geophysical prospection in the territory of the Roman town of Aesernia, Central-Southern Italy
19. Apostolos Sarris, Jamieson Donati, Tuna Kalayci, Carmen Cuenca García, François-Xavier Simon, Meropi Manataki, Pegky Triantafylopoulou
Towards an integrated remote-sensing strategy for revealing the urban details of the Hellenistic-Roman city of Demetrias, central Greece
20. Arne Anderson Stamnes
Using magnetic survey methods to delimit and characterize prehistoric iron production sites in Norway
21. Adam Szyrkiewicz
GPR research around the Hawara pyramid (Fayum, Egypt)
22. Yoon Jung Choi, Johannes Lampel, David Jordan, Sabine Fiedler, Thomas Wagner
Principal component analysis (PCA) of buried archaeological remains by VIS-NIR spectroscopy.

**DAY 2, WEDNESDAY 16.09.2015,
OLD LIBRARY, UNIVERSITY OF WARSAW**

Integrated prospection approaches.

Chairman: Lawrence B. Conyers

- 9.00-9.20 Chrys Harris, Chris Gaffney, Finnegan Pope-Carter, James Bonsall, Robert Fry, Andrew Parkyn
High Royds: An integrated, analytical approach for mapping the unmarked burials of a pauper cemetery
- 9.20-9.40 Melda Kucukdemirci, Salvatore Piro, Elif Ozer, Niyazi Baydemir, Daniela Zamuner
An integrated geophysical survey at Aizanoi archaeological site (Turkey)
- 9.40-10.00 Miron Bogacki, Barbara Kaim, Wiesław Małkowski, Krzysztof Misiewicz
Archaeological prospection in Serakhs oasis in Turkmenistan
- 10.00-10.20 Erich Nau, Lis Helles Olesen, Petra Schneidhofer, Manuel Gabler, Roland Filzwieser, Esben Schlosser Mauritsen
Large-scale high-resolution GPR and magnetometry prospection in West Jutland, Denmark
- 10.20-10.40 Petra Schneidhofer, Erich Nau, Alois Hinterleitner, Agata Lugmayer-Klimczyk, Jan Bill, Terje Gansum, Wolfgang Neubauer, Knut Paasche, Sirri Seren, Erich Draganits, Immo Trinks
Geoarchaeology as an essential supplement for large-scale, high-resolution archaeological geophysical prospection: case study of Gokstad in Norway
- 10.40-11.10 COFFEE AND TEA BREAK

Integrated prospection approaches/ GIS and prospection.

Chairman: Gregory Tsokas

- 11.10-11.30 Sirri S. Seren, Ralf Totschnig, Alois Hinterleitner, Klaus Löcker, Sabine Ladstätter
Archaeological prospection results in the surroundings of the Serapeion at Ephesus, Turkey
- 11.30-11.50 Hannah Brown, Mary K. Saunders
A binocular view of a marginal landscape: GIS and geophysics in the Yorkshire Dales National Park

- 11.50-12.10 Mariangela Noviello, Angelos Chliaoutakis, Marcello Ciminale,
Jamieson C. Donati, Apostolos Sarris
Neolithic settlements in the Tavoliere Plain (Apulia, Southern Italy): predictive probability maps
- 12.10-12.30 Valeria Poscetti, Georg Zotti, Wolfgang Neubauer
Improving the GIS-based 3D mapping of archaeological features in GPR data
- 12.30 - 12.50 Piotr Wroniecki, Marcin Jaworski, Mikołaj Kostyrko
Exploring free LiDAR derivatives. A user's perspective on the potential of readily available resources in Poland
- 12.50 - 14.20 LUNCH

Integrated prospection approaches / Interpretation and presentation of prospection results.

Chairman: Michel Dabas

- 14.20 - 14.40 Immo Trinks, Gregory Tsokas, Geert Verhoeven, Klaus Löcker, Matthias Kucera, Erich Nau, Mario Wallner, Panagiotis Tsourlos, Vargemezis George, Maurizio Forte, Wolfgang Neubauer
Mapping the Bronze Age settlement of Akrotiri on Santorini: digital documentation and archaeological prospection
- 14.40 - 15.00 Dennis Wilken, Tina Wunderlich, Jasmin Andersen, Wolfgang Rabbel
Geophysical investigation of past harbours: challenges and application examples
- 15.00 - 15.20 Tomasz Chmielewski, Mirosław Furmanek, Maksym Mackiewicz, Bartosz Myślecki, Anna Zakościelna
Landscape with enclosures. Magnetic prospection and surface survey of the Dobużek Scarp microregion in Eastern Poland
- 15.20 - 15.40 Lawrence B. Conyers
Ground-penetrating radar data analysis for more complete archaeological interpretations
- 15.40 - 16.00 Alan W. Mann, Graham C. Sylvester
Distribution of gold and silver in European soils: Evidence for a Roman footprint?
- 16.00 - 16.40 COFFEE AND TEA BREAK

History of archaeological geophysics / Archaeological feedback.

Chairman: Mahmut Drahor

- 16.40 - 17.00 Guillaume Hulin, Christophe Maneuvrier, Alain Tabbagh, Jean-Baptiste Vincent
A geophysical survey at Schlumberger's Val Richer residence: between archaeology and the history of science
- 17.00 - 17.20 Klaus Löcker, Matthias Kucera, Immo Trinks, Wolfgang Neubauer
Successfully falsified... On epistemological problems of archaeological excavations and geophysical surveys
- 17.20 - 17.40 Cornelius Meyer, Dana Pilz, Lise Goossens, Sabah Jasim, Joaquín Córdoba, Carmen del Cerro
Sands of time – archaeo-geophysical prospection results from the Emirate of Sharjah
- 17.40 - 18.00 Przemysław Dulęba, Jacek Soida, Piotr Wroniecki
Searching for Celts in Upper Silesia. Verification by excavation of a geophysical survey in Samborowice
- 18.00-19.00 POSTER SESSION 2
- 20.00 – 23.00 WINE / BEER PARTY IN CLUB HARENDA

POSTER SESSION 2

23. Burkart Ullrich, Gijs Tol, Tymon de Haas
An UMO landed on the Via Appia. Results of the Minor Centres Project in the Pontine plain, Lazio (Italy)
24. Andreas Viberg, Magnus Larson
Mobile laser scanning and 360° photography for the documentation of the Iron Age ring fort at Gråborg, Öland, Sweden
25. Aleksander Limisiewicz, Aleksandra Pankiewicz, Adam Szykiewicz
Archaeological excavation and GPR prospection indelinating defensive embankments on Ostrów Tumski (Cathedral Island) in Wrocław (Lower Silesia, Poland)
26. Mirosław Furmanek, Krzysztof Gediga, Urszula Piszcz, Artur Rapiński
Geochemical and magnetic prospection of a Neolithic site: case study from Dzielnica (Poland)

27. Anna Zalewska, Michał Jakubczak, Jacek Czarnecki
Archaeological revival of memory of the Great War. The role of LiDAR in tracing the boundaries of the planned Cultural Park "The Rawka Battlefield (1914–1915) — in memory of war victims"
28. Mário Bielich, Martin Bartík and Elena Blažova
Geophysical survey at Žitnýostrov, Slovakia, in 2012–2013
29. Irina A. Arzhantseva, Sergey A. Erokhin, Igor N. Modin, Dina A. Kvon, Alexandra M. Pavlova, Tatiana V. Shishkina, Eugene O. Zerkal
Geophysical studies of Djankent fortress in the eastern Aral sea region (Kazakhstan)
30. Simone Mühl, Jörg W. E. Fassbinder
Archaeological geophysics in the Shahrizor plain (Iraqi Kurdistan)
31. Ekhine Garcia-Garcia, Juantxo Agirre-Mauleon, James Andrews, Arantza Aranburu, Haizea Arrazola, Joxe Etxegoien, Juan José Fuldáin, Julian Hill, Eneko Iriarte, Mikel Legorburu, Juanmari Txoperena, Mary Nicholls, Peter Rauxloh, Rafa Zubiria
Geoarchaeological core prospection investigation to improve the archaeological interpretation of geophysical data: case study of a Roman settlement at Auritz (Navarre)
32. Chrys Harris, Chris Gaffney, Mark Newman, Mike Langton, Roger Walkerand, Mariah Ottersen
Ghosts, surprises, and unsolved mysteries: a multi-technique approach to the enigmatic third guesthouse at Fountains Abbey
33. Roman Křivánek
"Atypical" use of combinations of geophysical methods for archaeological heritage preservation in the Czech Republic
34. Tadeusz Magiera, Maria Mendakiewicz, Leszek Chróst
Magnetic prospection of areas of medieval and prehistoric ore smelting around Miasteczkośląskie (southern Poland)
35. Nikos Papadopoulos, Ian Moffat, Jamie Donati, Apostolos Sarris, Tuna Kalayci, Gianluca Cantoro, Nasos Argyriou, Kayt Armstrong, François-Xavier Simon
Geophysical mapping of a classical Greek road network: a case study from the city of Elis, Peloponnese
36. Michael Rogers, Scott Stull
Visualizing an integrated landscape through ground-based LiDAR, geophysical archaeology, and archaeological excavation
37. Jerzy Sikora, Piotr Kittel, Piotr Wroniecki
To not see the forest for the trees. A non-invasive approach to the Góra Chełmo medieval hillfort
38. Jerzy Sikora, Piotr Kittel, Piotr Wroniecki
From a point on the map to a shape in the landscape. Non-invasive verification of medieval ring-forts in Central Poland: Rozprza case study

39. Immo Trinks, Gregory Tsokas, Geert Verhoeven, Klaus Löcker, Matthias Kucera, Erich Nau, Mario Wallner, Panagiotis Tsourlos, Vargemezis George, Wolfgang Neubauer
Mapping the Bronze Age settlement of Akrotiri on Santorini: digital documentation and archaeological prospection
40. Andreas Viberg
The Big Five. Mapping the subsurface of Iron Age forts on the Island of Öland, Sweden
41. Dennis Wilken, Tina Wunderlich, Bente Majchczack, Jasmin Andersen, Wolfgang Rabbel
Seismic resonance analysis to map a Viking Age pit house: comparison to GPR and magnetics
42. Dennis Wilken, Tina Wunderlich, Wolfgang Rabbel, Davide Zori, Sven Kalmring, Jesse Byock
Imaging the AD 1500 Katla tephra inside the Leiruvogur "Inner Skiphóll" harbour using GPR
43. Tina Wunderlich, Dennis Wilken, Jasmin Andersen, Wolfgang Rabbel, Davide Zori, Sven Kalmring, Jesse Byock
Mapping medieval turf buildings with geophysical methods
44. Tina Wunderlich, Dennis Wilken, Ercan Erkul, Wolfgang Rabbel, Andreas Vött, Peter Fischer, Hanna Hadler, Stefanie Ludwig, Michael Heinzlmann
The harbour(s) of ancient Ostia. Archaeogeophysical prospection with shear wave seismics, geoelectrics, GPR and vibracorings
45. Tina Wunderlich, Dennis Wilken, Paul-Benjamin Riedel, Martina Karle, Sebastian Messal
Marine magnetic and seismic measurements to find the harbour of the early medieval Slavic emporium Groß Strömkendorf/Reric, Germany
46. Gheorghe Romanescu, Ionut Cristi Nicu
Evolution of human settlements and natural risk factors. A case study of Chalcolithic archaeological sites in the Valea Oii watershed (Romania)
47. Carmen Cuenca-Garcia, Apostolos Sarris, Christina Makarona, Andreas Charalambos, Marina Faka, Iosif Chafez, Sorin Hermon, Vasiliki Kassianidou, Karin Nys
Integrated geophysical and in-situ soil geochemical survey at Dromolaxia-Vizakia (Hala Sultan Tekke, Cyprus)

**DAY 3, THURSDAY 17.09.2015,
OLD LIBRARY, UNIVERSITY OF WARSAW**

Processing and visualisation of data.

Chairman: Apostolos Sarris

- 9.00-9.20 Philippe De Smedt, Samuël Delefortrie, Marc Van Meirvenne
Good practice in high-resolution EMI data processing for archaeological prospection
- 9.20-9.40 Paul S. Johnson, Alex Mullen, Lieven Verdonck, Lacey Wallace
The Canterbury Hinterland Project: understanding dynamic rural landscapes through the semi-automated interpretation of geophysical survey results
- 9.40-10.00 Philippe Marty, Darras Lionel, Jeanne Tabbagh, Christophe Benech, François- Xavier Simon, Julien Thiesson
WuMapPy, an open-source software for geophysical prospection data processing
- 10.00-10.20 Roman Pašteka, Peter Milo, David Kušnirák, Tina Wunderlich, Dennis Wilken, René Putiška, Jozef Urminský, Juraj Papčo, Igor Murín
Role of regularized derivatives in magnetic edge mappers evaluation
- 10.20-10.40 Armin Schmidt
Easy targets, or "who has marked out my anomalies"?
- 10.40-11.10 COFFEE AND TEA BREAK

Interpretation and presentation of prospection results.

Chairman: Martijn van Leusen

- 11.10-11.30 Christian Gugl, Wolfgang Neubauer, Erich Nau, Renate Jernej
New evidence for a Roman military camp at Virunum (Noricum)
- 11.30-11.50 Alois Hinterleitner, Klaus Löcker, Wolfgang Neubauer, Immo Trinks, Vlad Sandici, Mario Wallner, Michael Pregesbauer, Karolin Kastowsky-Priglinger
Automatic detection, outlining and classification of magnetic anomalies in large-scale archaeological magnetic prospection data

- 11.50-12.10 Jörg W.E. Fassbinder, Lena Kühne, Melanie Flossmann–Schütze
The Hellenistic settlement of Tuna el-Gebel
- 12.10-12.30 Chiara Marcotulli, Salvatore Piro, Sara Pasquarelli, Daniela Zamuner, Guido Vannini
New data from an urban archaeology project on a medieval town site. High-resolution GPR surveys in Piazza delle Carceri, Prato (Florence, Italy)
- 12.30 - 12.50 Apostolos Sarris, Nikos Papadopoulos, William A. Parkinson, Richard W. Yerkes, Attila Gyucha, Gábor Bácsmegi, Francois-Xavier Simon, Paul R. Duffy, Rod Salisbury
Unfolding the Neolithic wetlands landscape of Szeghalom-Kovácsshalom in Hungary

12.50 - 14.20 LUNCH

Interpretation and presentation of prospection results.

Chairman: Stefano Campana

- 14.20 - 14.40 Apostolos Sarris, Tuna Kalayci, François-Xavier Simon, Jamieson Donati, Carmen Cuenca García, Meropi Manataki, Gianluca Cantoro, Georgia Karampatsou, Evita Kalogiropoulou, Nassos Argyriou, Sylviane Dederix, Cristina Manzetti, Nikos Nikas, Konstantinos Vouzaxakis, Vasso Rondiri, Polyxeni Arachoviti, Kaliopi Almatzi, Despina Efstathiou, Evangelia Stamelou
Cultural variations of the Neolithic landscape of Thessaly
- 14.40 - 15.00 Michael Schneider, Sven P. Linzen, Markus Schiffler, Andreas Wunschel, M. Hein, Christopher-Bastian Roettig, Stefan Dunkel, Ronny Stolz, Peter Ettel, Hans-Georg Meyer, Daniel Baumgarten
SQUID-based magnetic prospection within interdisciplinary case studies at possible early and high medieval harbor sites in Germany
- 15.00 - 15.20 Francois-Xavier Simon, Alain Tabbagh, Apostolos Sarris
Measurement of the dielectric permittivity through multi-frequency EMI for archaeological prospection
- 15.20 - 15.40 Graham C. Sylvester, Alan W. Mann, Andrew Rate, Clare A. Wilson
The application of mobile metal ion (MMI) geochemistry to the definition and delineation of the Roman metal processing site, St. Algar's Farm, Somerset, United Kingdom

15.40 - 16.00 Burkart Ullrich, Pawel Wolf
Hamadab near Meroe (Sudan): results of multi-technique geophysical surveys

16.00 - 16.40 COFFEE AND TEA BREAK

Technical aspects.

Chairman: Salvatore Piro

16.40 - 17.00 Neil Linford, Paul Linford, Andy Payne
First results from a new ground-coupled multi-element GPR array

17.00 - 17.20 Gaetano Ranieri, Antonio Trogu, Luca Piroddi, Sergio Calcina, Francesco Loddo, Carlo Piga, Raimondo Zucca, Alessandro Usai, Paolo Bernardini, Piergiorgio Spanu, Emina Usai, Barbara Panico, Adriana Scarpa, Luciana Tocco
The New Archaeology. From remote sensing to archaeological digging in quasi-real time. The case of "Monte Prama" (Sardinia, Italy)

17.20 - 17.40 Gregory N. Tsokas, Panagiotis I. Tsourlos, George Vargemezis
Geophysical investigations of tumuli: a continuously challenging problem

17.40 - 18.00 James Bonsall, Christopher Gaffney, Ian Armit
You know it's summer in Ireland when the rain gets warmer: analysing repetitive time-lapse earth resistance data to determine 'optimal' survey climate conditions

18.00-19.00 POSTER SESSION 3

20.00-23.00 GALA DINNER, COLUMN HALL, INSTITUTE OF HISTORY, UNIVERSITY OF WARSAW

POSTER SESSION 3

48. Akram M. Aziz, El-Arabi H. Shendiand, Mohamed Abd El-Maksoud
Role of potential field derivatives in delineating buried archaeological ruins
49. Meric Aziz Berge, Mahmut Goktuğ Drahor
Resistivity modelling and inversion of square array for archaeological investigations
50. Fumihiko Chishima, Hiroyuki Kamei
The influence of sampling interval on accuracy of probabilistic attenuation correction for GPR signal
51. Armin Schmidt, Kayt Armstrong, Martijn van Leusen
Using archaeological models for the inversion of magnetometer data
52. Francois-Xavier Simon, Alfredo Mayoral Pascual, Franck Vautier, Yannick Miras
Refinement of ALS point cloud through the assessment of bare-earth classification algorithms: the AYPONA Project case study
53. Kleanthis Simyrdanis, Nikos Papadopoulos, Theotokis Theodoulou
Optimization of electrical resistivity tomography protocols for detecting archaeological structures in shallow water marine environment
54. András Bődöcs, Zoltán Czajlik, Sándor Berecki
Non-destructive survey of Iron Age cemeteries: testing the topographic support system
55. Julia Chyla, Wojciech Ejsmond, Jakub Ordutowski, Piotr Witkowski, Dawid F. Wieczorek, Daniel Takács, Marzena Ożarek-Szilke
Comprehensive field survey at Gebelein: preliminary results of a new method in processing data for archaeological site analysis
56. Jerzy Czerniec, Krystian Kozioł, Krzysztof Misiewicz
Cultural landscape. Geomorphometric studies in the Chełmno Land
57. Kayt Armstrong, Tymon de Haas, Gijs Tol
The whole is greater than the sum of the parts: combining fieldwalking data and geophysical survey in the study of minor Roman centres
58. Andrei Asăndulesei
Magnetic prospecting of Chalcolithic sites in north-eastern Romania: some considerations of intra-site spatial organisation
59. Roman Křivánek, Petr Čech, Michal Soukup
Geophysical prospection and rescue archaeological excavation of subsurface WWII remains in the foreland of brown coal mines in northwestern Bohemia
60. Cornelius Meyer, Henning Zöllner, Dana Pilz, Barbara Horejs, Albrecht Matthaei
LEA MAX – the multi-purpose gradiometer array in the fields of the Kaikos valley (Bergama, Turkey)
61. Roksana Chowaniec, Krzysztof Misiewicz
Comparison of the results of magnetic and gradient surveys with the real

situation in the field on the basis of excavations at Akrai/Acrae, south-eastern Sicily. New possibilities for the interpretation of geophysical maps

62. Michał Pisz, Łukasz Pospieszny

The Tibiscum project - non-destructive research in Romania.

63. Christelle Sanchez, Julien Thiesson, Félix Relats-Monteserrat, Roger Guérin, Fayçal Réjibaand Dominique Valbelle

Reconstructing the history of the planning of the Medamoud temple: magnetic and electromagnetic prospecting results

64. Jan Bulas, Joanna Zagórska-Telega, Piotr Wroniecki

Non-invasive prospection of two Iron Age sites in Michałowice, southern Poland

65. Łukasz Pospieszny, Mateusz Cwaliński, Janusz Czebreszuk, Mateusz Jaeger, Jakub Niebieszczański, Mateusz Stróżyk

Uncovering a Bronze Age landscape. A case study from Krotoszyn Forest (Poland)

66. Agata Lugmayer-Klimczyk, Sebastian Flöry, Matthias Kucera, Wolfgang Neubauer, Klaus Löcker, Eamonn Baldwinand, Vincent Gaffney

Terrestrial laser scanning of the landscape around Stonehenge

67. Annika Fediuk, Ercan Erkul, Tina Wunderlich, Wolfgang Rabbel

Comparative study of accuracy of caesium, Overhauser and fluxgate magnetometers in field conditions

COPERNICUS SCIENCE CENTRE



DAY 4, FRIDAY 18.09.2015, COPERNICUS SCIENCE CENTRE

Interpretation and presentation of prospection results

Archaeological feedback.

Chairman: Christophe Benech

- | | |
|------------|--|
| 9.00-9.20 | Jörg W.E. Fassbinder, Anton Gass, Ina Hofmann, Andrei B. Belinskij, Hermann Parzinger
<i>Early Iron Age kurgans from the North-Caucasus</i> |
| 9.20-9.40 | Mario Wallner, Klaus Löcker, Wolfgang Neubauer, Michael Doneus, Viktor Jansa, Geert Verhoeven, Immo Trinks, Sirri Seren, Christian Gugl, Franz Humer
<i>ArchPro Carnuntum Project. Large-scale non-invasive archaeological prospection of the Roman town of Carnuntum</i> |
| 9.40-10.00 | Tomas Tencer, Wolfgang Neubauer
<i>Urban spatial analyses of geophysical archaeological prospection data from the Roman civil town Carnuntum, Austria</i> |

- 10.00-10.20 Joachim Schultze, Barbara Wouters
Geophysical survey - archaeological excavation - micromorphological analysis. What do geomagnetic anomalies show? An example from Hedeby
- 10.20-10.40 Roman Křivánek
The potential and limitations of geophysical measurements on archaeological sites partly investigated in the past: case studies from the Czech Republic
- 10.40-11.00 Tomasz Herbich
Geophysical surveying in Egypt: periodical report for 2013-2015
- 11.00-11.30 COFFEE AND TEA BREAK

Archaeological feedback – special session 1.

Chairman: Neil Linford

- 11.30-12.00 Stefano Campana
Emptyscapes: filling 'empty' mediterranean landscapes, mapping the archaeological continuum
- 12.00-12.30 P. Martijn van Leusen
Closing the loop. Extracting more value out of archeogeophysical surveys in the Raganello Basin
- 12.30-13.00 Irene Forstner-Müller, Tomasz Herbich, Vera Michel, Christian Schweitzer
Archaeological and geophysical survey of Tell el-Dab^a, an ancient town in the Nile Delta
- 13.00-14.30 LUNCH

Archaeological feedback – special session 2.

Chairman: Immo Trinks

- 14.30-15.00 Christophe Benech
Contribution of geophysics to research on city planning in the ancient and classical Near East
- 15.00 - 15.30 Benno Zickgraf
Geophysical survey or archaeological prospection? A plea for archaeological feedback
- 15.30 - 16.00 Włodzimierz Rączkowski, Tomasz Herbich
Creating a new standard: medieval town(s) within remote sensing perspective

16.00-16.30 COFFEE AND TEA BREAK

Archaeological feedback – special session 3.

Chairman: Jörg Fassbinder

- 16.30 -17.00 Barbara Helwing
What you see is what you get: some reflections on the impact of geophysical data on the strategies of archaeological fieldwork, based on case studies from Iran and Azerbaijan
- 17.00 – 17.30 Nadine Dieudonné-Glad
Do magnetic and electric survey results correlate with archaeological evidence? Case studies
- 17.30 - 18.00 Raimund Kastler
The multiple benefits of archaeological geophysical prospection in Salzburg. Ten years of archaeological feedback in retrospect
- 18.00 - 19.00 ISAP GENERAL ASSEMBLY

WILANÓW

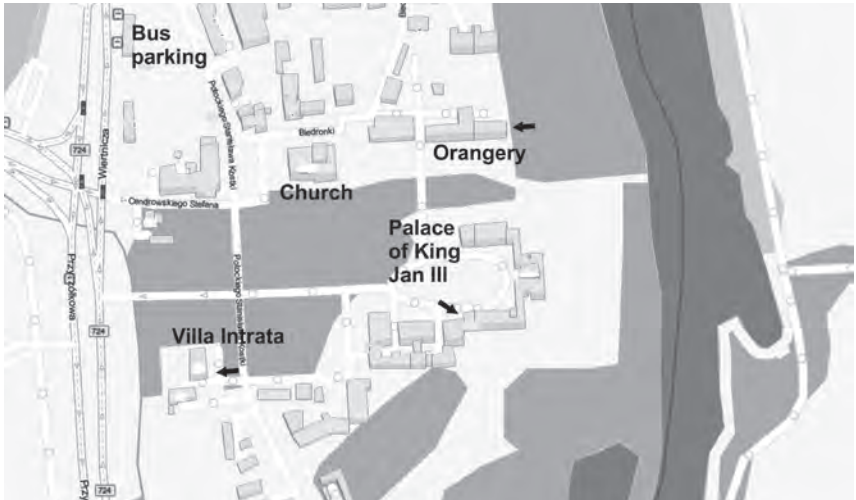

DAY 5, SATURDAY 19.09.2015, PALACE OF KING JAN III SOBIESKI IN WILANÓW

Conference excursion to the Museum of King Jan III's Palace in Wilanow

- 9.30 Departure from the Old Library at the University Campus
- 10.00 – 10.45 Andrzej Gołembnik
Searching for the graphic forms of synthesis – a new perspective (presentation at the Palace's orangery)
- 11.00 – 13.00 Visit to the Palace Museum (guided tour)
- 13.00 - 15.00 Barbeque in the Villa Intrata in the Palace gardens (tasting of traditional Polish food)

USEFULL INFO

REGISTRATION

The registration desk will be open in the hall of the Old University Library from 4 p.m. to 8 p.m. on Monday, 14th of September, and from 8.30 a.m. on Tuesday, 15th of September.

If you arrive after the registration time, please contact a member of the organizing team.

CONFERENCE VENUES

On September 15,16 and 17 the conference will be held in the Old Library of the University of Warsaw, a building located centrally in the Old University Campus, opposite the main gate from Krakowskie Przedmieście street. It lost its former function when the New Library was built (near the Copernicus Science Center) and was changed into a modern and very successful complex of lecture halls.

On September 18 the conference will move to the Copernicus Science Center at 20 Wybrzeże Kościuszkowskie Street. The lecture hall is entered through the entrance located about the middle of the building, to the right of the visitors' entrance (when facing the building). The walk to the Center from the University takes about 10 minutes. On the way take a look at the interesting architecture of the New Library (www.buw.uw.edu.pl/56/66 Dobra Street). The rooftop gardens of the New Library are well worth a visit.

On September 19 participants will have the opportunity to visit the Palace at Wilanów, the residence of King John III Sobieski, the commander of the army that rescued Vienna from the Turks in 1683. The visit will be preceded by a presentation in the Palace Orangery of archaeological documentation methods using modern documentation techniques. After the visit guests will partake of specialties of (not only) Old Polish cuisine.

CONFERENCE LUNCHES

Lunches will be served at the Harena Club which is situated near the main University Campus (in the same building as the Harena hotel). Participants will be able to choose vegetarian or non vegetarian menus. In the conference kit you will find tickets for 4 lunches (Tuesday – Friday, each ticket will have dates and hours of lunch breaks) and invitations to evening events. Please take into account that lunch break hours are different every day.

EVENTS

A rich program of social events is a well-established tradition of Archaeological Prospection conferences and the AP2015 Warsaw organizing team will absolutely not break this custom.

On the first day of the conference, on Tuesday, 15 September, the participants will meet at Pałac Kazimierzowski (Rectorate located on the main campus) for a welcome reception.

A non-formal social event - a wine & beer party - will be organized at the nearby Harena Club on Wednesday, 16 September.

The Gala Dinner will take place in the historic column hall of the Institute of History (also located on the main campus) on Thursday, 17 September.

An excursion to the Palace of King Jan III Sobieski in Wilanów will take place on Saturday, 19 September. The visitors will be divided into groups headed by museum guides. This will be preceded by Andrzej Gołębniak's presentation titled "*Searching for the graphic forms of synthesis – a new perspective*". The presentation will be based on his interdisciplinary archaeological research conducted in the years 2003-2011 at the Wilanów Palace. After the sightseeing tour all participants are invited to a barbeque in the palace gardens (to taste traditional Polish food).

INFORMATION FOR SPEAKERS

ORAL PRESENTATIONS cannot be longer than 20 minutes (including 5 min for discussion). The conference hall is equipped with a digital data projector system. To use the digital data projector system, the organizers will provide a PC with Windows and Powerpoint programs. Personal laptops may be used as well, although to save time (and the hassle of connecting equipment) the organizers highly recommend using the provided equipment for presentations saved on USB memory sticks.

Important information for Macintosh users: please note that you should provide your own computer and confirm that it has a VGA socket for external signal or an adapter that connects your Mac with a projector.

POSTERS will be presented by their authors in three one-hour sessions and will take place successively on September 15, 16 and 17. Authors are requested to be present by their posters during the respective poster sessions as announced.

Poster dimensions are dictated by stand size and cannot exceed 90 cm in width (horizontally). As for height, the stands are slightly higher than the average viewer and for reader's comfort we advise that they do not exceed 150 cm. All equipment and materials necessary to mount the posters will be available on the spot.

Posters may be installed from Monday, 14 September after 4 pm, and from 8 a.m. on Tuesday, and have to be removed by Friday evening (18 September).

INTERENT ACCESS

The University of Warsaw provides free wireless Internet access. Please find the network ICAP2015net and use the password ICAP2015. A computer room will be available on the second floor of the Old Library Building (Conference venue) as well. The University provides computers in the Computer room, which are connected to the Internet.

COMING TO THE CONFERENCE VENUE

Participants arriving at the Frederic Chopin Airport can reach the city center by bus, train or taxi.

Bus: Line 175 (www.ztm.waw.pl; www.jakdojade.pl). Bus stop Uniwersytet is just in front of the University's main gate.

Participants staying at the Gromada Hotel may get off Bus 175 at Krucza or Ordynacka bus stops, which are both 400 m. from the hotel. The same directions apply to the participants arriving at Dworzec Centralny (Main Railway Station). To reach the Hera University Guest House from the airport you get off Bus 175 at Foksal 02, walk across the street to the Foksal 01 bus stop (opposite direction), get on Bus 116 or 180, and then get off at Spacerowa bus stop – approx. 50 m. from the hotel.

Participants staying at the Hera University Guest House can reach the main University Campus by numerous buses (from Spacerowa 02 bus stop): lines 116, 180, 503 ('on demand stop'). The same buses go back from the University to the hotel. The journey takes approx. 20 minutes.

Train: Take line S2 to Warszawa Śródmieście station. The Station is approx. 15 min. walking distance from the University or take two stops by metro: first by M1 line from Centrum station, change to M2 line on Świętokrzyska station and get off at Nowy Świat – Uniwersytet station.

Taxi: For safety reasons we advise you to use licensed taxi services offered at the airport (Sawa Taxi - +4822 644 44 44; Super Taxi - 196 22; Ele Taxi - +4822 8111 111; Cab-Taxi +4822 644 22 22). Taxi tariffs (price per 1 km) should be clearly displayed in the car window. In some taxis you may also pay the fare with a credit card – look for the sticker or ask the driver. The approximate price from the airport to the city center is 40-50 PLN. See also the airport website www.lotnisko-chopina.pl.

We recommend the jakdojade.pl internet service for checking further transport options in Warsaw (www.warszawa.jakdojade.pl)

Participants arriving at the Modlin Airport can reach the city center by bus or taxi. There are several bus companies (e.g. www.modlinbus.com) that connect the airport with Central Warsaw (the Palace of Culture area, 15 min. walking distance to the conference venue). The airport is 35 km away and the trip takes usually about 40 minutes.

Car: Please bear in mind that the Krakowskie Przedmieście and Nowy Świat streets are closed to non-public transportation and drivers entering them may be fined. Nearby streets are open to all, and parking spaces are to be found even in rush hour. Warsaw's city center has paid parking spaces on weekdays from 8:00 am. to 6 pm. One hour costs around 1 euro. Payment is made beforehand in parking meters.

PUBLIC TRANSPORT

It is fairly easy to use public transport in Warsaw, just remember that you have to validate your ticket immediately after getting on the bus/tram/train (if you're traveling by metro, validate the ticket at the entrance gate). You may sometimes buy tickets from the driver (exact change required), in every newsstand or at a ticket machine (preferred method). There are a few types of short-term tickets: for 20 minutes: 3,40 PLN; for 75 minutes: 4,40 PLN; 24 hour: 15,00 PLN; which entitle the ticket-holder to unlimited journeys with as many changes of lines as necessary, within the time limit. Students from foreign uni-

versities younger than 26 are entitled to a 50% fare reduction with a valid ISIC card (International Student Identity Card). More about transport in Warsaw: www.ztm.waw.pl. You may also purchase tickets from ticket machines in buses and trams, however most often you can only pay with a card.

Public transportation works from about 5:00 am. to 11:30 pm. Some lines finish their courses earlier, and some later. There are also special night bus lines – beginning with N (eg. N43, N41). The aforementioned jakdojade.pl service has timetables of the night buses.

EMERGENCY AND ASSISTANCE

In case of an accident or any trouble, please call emergency number **112** or one of the following numbers: **999 – ambulance; 998 – fire brigade; 997 – police.**

In case of an emergency you may also contact the organizers: Piotr Wroniecki +48 608 802 025; Robert Ryndziejewicz +48 500 049 225; Krzysztof Kiersnowski +48 694 349 103,

CURRENCY EXCHANGE

The official currency in Poland is the Polish złoty (PLN): 1 euro = c. 4,23 PLN; 1 dollar = c. 3,75 PLN.

Currency can be exchanged at banks, exchange offices (bureaus de change – kantor) and sometimes in hotels. No exchange fee (commission) is charged. The participants are advised not to exchange money at the bureau de change at the Airport, as their exchange rates are not very favorable. ATMs are available almost everywhere in Warsaw and all popular credit cards are accepted widely.

ELECTRICITY

The voltage in Poland is 230 V, 50 Hz and European plugs with two circular metal pins are used.

A SMARTPHONE GUIDE TO EVENTS, FOOD, CLUBS

Users of smartphones may use a non-commercial, interactive and free map-guide to Warsaw: www.use-it-warsaw.pl

WHAT YOU MUST SEE IN WARSAW AND WHY *subjectively Tomasz Herbich*

The Faras Gallery at the National Museum in Warsaw, because it is the only place in the world beside Sudan where you can see a huge collection of medieval Nubian Christian painting, discovered and protected during rescue excavations that were carried out before the region was flooded by waters of the Nasser Lake in Aswan.

The Royal Castle, because it is the only royal residence in Europe that is standing on the spot of grassy lawns with benches for visitors that were there only forty years ago. The Castle was razed to the ground during World War II and was rebuilt from the foundations up using old documentation and fragments of architectural decoration salvaged from the smoking ruins by dedicated museum workers during the war.





New Library

Copernicus Science Center

UNIVERSITY OF WARSAW

Old Library

Pałac Kazimierzowski

Institute of History

main gate

gate

Harenda

Powiśle

National Museum